

OPERA 2PH

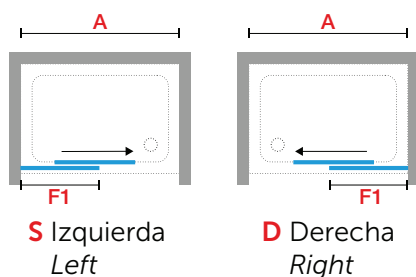

MAMPARA DE 2 HOJAS: 1 CORREDERA + 1 FIJA
 SHOWER DOOR, 1 SLIDING DOOR + 1 FIXED PANEL IN LINE
 SOFT CLOSING

Medidas Dimensions			Código Code	Izquierda Left	Derecha Right	Cristales Glass		Perfiles Profile type		
Extensibilidad Actual dimensions	Fijo frontal Fixed panel	Entrada Access		S-	D-	1	51	U	B	K
A	F1	*				Transparente Clear	Serig. Ravenna Ravenna print.	Blanco mate White soft	Silver	Cromo Chrome
87 ↔ 90	40,8	37,3	OPE2PH87	S-	D-					
90 ↔ 93	42,3	38,8	OPE2PH90	S-	D-					
97 ↔ 100	45,8	42,3	OPE2PH97	S-	D-					
100 ↔ 103	47,3	43,8	OPE2PH100	S-	D-					
117 ↔ 120	55,8	52,3	OPE2PH117	S-	D-					
120 ↔ 123	57,3	53,8	OPE2PH120	S-	D-					
137 ↔ 140	65,8	62,3	OPE2PH137	S-	D-					
140 ↔ 143	67,3	63,8	OPE2PH140	S-	D-					
147 ↔ 150	70,8	67,3	OPE2PH147	S-	D-					
150 ↔ 153	72,3	68,8	OPE2PH150	S-	D-					
157 ↔ 160	75,8	72,3	OPE2PH157	S-	D-					
160 ↔ 163	77,3	73,8	OPE2PH160	S-	D-					
167 ↔ 170	80,8	77,3	OPE2PH167	S-	D-					
170 ↔ 173	82,3	78,8	OPE2PH170	S-	D-					
177 ↔ 180	85,8	82,3	OPE2PH177	S-	D-					
180 ↔ 183	87,3	83,8	OPE2PH180	S-	D-					
197 ↔ 200	95,8	92,3	OPE2PH197	S-	D-					
200 ↔ 203	97,3	93,8	OPE2PH200	S-	D-					

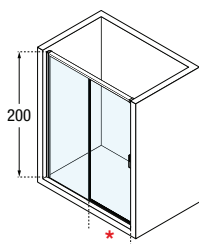

Construcción del código:
 Construction of the code:

Código Code + Izquierda / Derecha Left / Right + Cristal Glass + Perfiles Profile = Código completo del producto Final product code



DATOS TÉCNICOS / TECHNICAL DATA

CRISTAL / GLASS TYPE 8 mm (European standards UNE EN 14428)

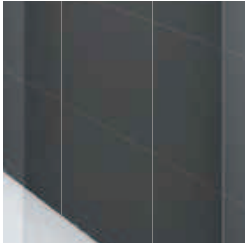

Transparente
Clear

COD. 1

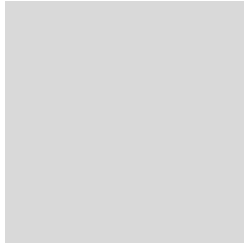

Serig. Ravenna
Ravenna Print.

COD. 51

TIRADOR / HANDLES



Tirador cromo
Chromed metal handles

COLORES PERFILES / PROFILE COLOURS



Blanco
White

COD. U



Silver

COD. B



Cromo
Chrome

COD. K

MEDIDAS QUE OCUPAN LOS PERFILES EN LA PARED / OVERALL DIMENSIONS FIXING PROFILES

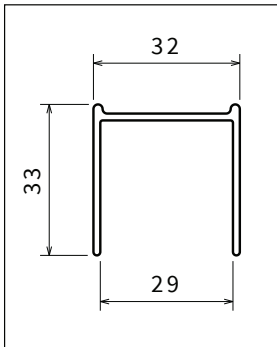

TOMA DE MEDIDAS / HOW TO TAKE THE MEASUREMENTS

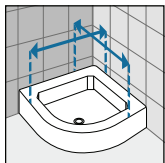
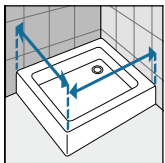

Tomar las medidas desde la pared hasta el borde externo del plato de ducha.
Take the measurements from wall to the external edge of the shower tray. Dimensions must be taken once the walls are finished and tiled, according to the above drawings.

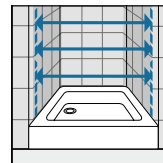

Tomar medidas de pared a pared, medir la parte baja, la central y la superior. Cursar el pedido con la medida más pequeña.
Take the measurements from wall to wall at the bottom, at the top, in the middle and use the smallest. Dimensions must be taken once the walls are finished and tiled, according to the above drawings.