

OPERA 2A



MAMPARA FRONTAL DE DOS HOJAS CORREDERAS + DOS FIJOS
 SHOWER DOOR, 2 SLIDING DOORS + 2 FIXED PANELS IN LINE
 SOFT CLOSING

Medidas Dimensions			Código Code	Cristales Glass		Perfiles Profile type		
Extensibilidad Actual dimensions	Fijo frontal Fixed panel	Entrada Access		1	51	U	B	K
A	F1	*		Transparente Clear	Serig. Ravenna Ravenna print	Blanco mate White soft	Silver	Cromo Chrome

PUERTA / DOOR

A	F1	*	Código	Cristales	Perfiles
117 ↔ 121	26,5	48	OPE2A117-		
121 ↔ 125	27,5	50	OPE2A121-		
125 ↔ 129	28,5	52	OPE2A125-		
129 ↔ 133	29,5	54	OPE2A129-		
133 ↔ 137	30,5	56	OPE2A133-		
137 ↔ 141	31,5	58	OPE2A137-		
141 ↔ 145	32,5	60	OPE2A141-		
145 ↔ 149	33,5	62	OPE2A145-		
149 ↔ 153	34,5	64	OPE2A149-		
153 ↔ 157	35,5	66	OPE2A153-		
157 ↔ 161	36,5	68	OPE2A157-		
161 ↔ 165	37,5	70	OPE2A161-		
165 ↔ 169	38,5	72	OPE2A165-		
169 ↔ 173	39,5	74	OPE2A169-		
173 ↔ 177	40,5	76	OPE2A173-		
177 ↔ 181	41,5	78	OPE2A177-		
197 ↔ 201	46,5	88	OPE2A197-		

PANEL FIJO / SIDE PANEL

F			Código	Cristales	Perfiles
67 ↔ 69	◇	◇	OPEF67-		
69 ↔ 71	◇	◇	OPEF69-		
75 ↔ 77	◇	◇	OPEF75-		
77 ↔ 79	◇	◇	OPEF77-		
79 ↔ 81	◇	◇	OPEF79-		
85 ↔ 87	◇	◇	OPEF85-		
87 ↔ 89	◇	◇	OPEF87-		
89 ↔ 91	◇	◇	OPEF89-		
95 ↔ 97	◇	◇	OPEF95-		
97 ↔ 99	◇	◇	OPEF97-		
99 ↔ 101	◇	◇	OPEF99-		
115 ↔ 117	◇	◇	OPEF115-		
117 ↔ 119	◇	◇	OPEF117-		

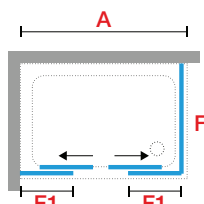
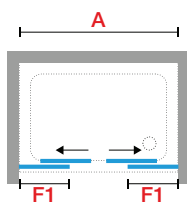
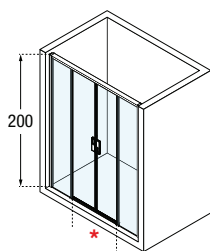

Construcción del código: Código + Cristal + Perfiles = Código completo del producto
 Construction of the code: Code + Glass + Profile = Final product code



DATOS TÉCNICOS / TECHNICAL DATA

CRISTAL / GLASS TYPE 8 mm (European standards UNE EN 14428)

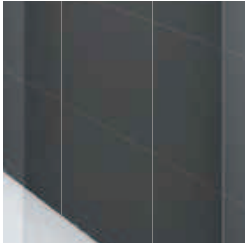

Transparente
Clear

COD. 1

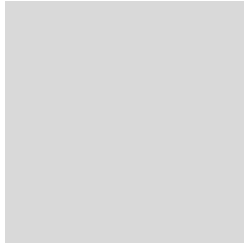

Serig. Ravenna
Ravenna Print.

COD. 51

TIRADOR / HANDLES



Tirador cromo
Chromed metal handles

COLORES PERFILES / PROFILE COLOURS



Blanco
White

COD. U



Silver

COD. B



Cromo
Chrome

COD. K

MEDIDAS QUE OCUPAN LOS PERFILES EN LA PARED / OVERALL DIMENSIONS FIXING PROFILES

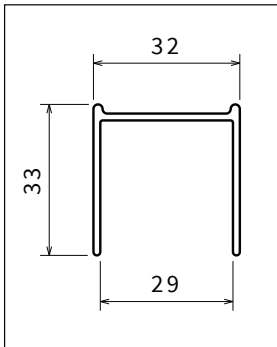

TOMA DE MEDIDAS / HOW TO TAKE THE MEASUREMENTS

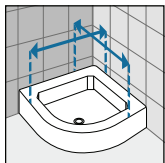
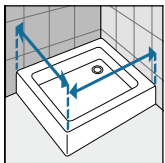

Tomar las medidas desde la pared hasta el borde externo del plato de ducha.
Take the measurements from wall to the external edge of the shower tray. Dimensions must be taken once the walls are finished and tiled, according to the above drawings.

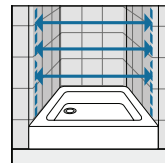

Tomar medidas de pared a pared, medir la parte baja, la central y la superior. Cursar el pedido con la medida más pequeña.
Take the measurements from wall to wall at the bottom, at the top, in the middle and use the smallest. Dimensions must be taken once the walls are finished and tiled, according to the above drawings.